



REFRIGERATION

SERVING THE FOOD INDUSTRY SINCE 1951

HEAVY DUTY GLASS DOOR BOTTLE COOLERS

Item: 50058
Model: BB-CN-0012-GH

Item: 50060
Model: BB-CN-0016-GH

Item: 50062
Model: BB-CN-0020-GH



KEEP BEVERAGES CHILLED AND READY TO SERVE

Perfect for any restaurant and/or bar, the heavy duty glass door bottle coolers are designed with enduring quality and value. The exterior comprises of attractive corrosion resistant vinyl on steel in black finish. Electronic control system makes it easy to adjust temperature set point and defrost frequency.



WARRANTY

2 YEARS PARTS & LABOR
5 YEARS ONLY ON COMPRESSOR



Authorized Dealer

REFRIGERATION

49-INCH HEAVY DUTY GLASS DOOR BOTTLE COOLER



Features:

- Durable stainless steel top, interior walls, floor and ceiling
- Exterior construction is attractive corrosion resistant vinyl on steel in black finish
- Self-closing doors with locks
- LED interior lighting
- Adjustable heavy-duty PVC coated shelves
- Electronic control system makes it easy to adjust temperature set point and defrost frequency
- Temperature range from 0-5°C / 33-41°F



TECHNICAL SPECIFICATION

| | |
|---------------------------|-----------------------------------------------------|
| ITEM NUMBER | 50058 |
| MODEL | BB-CN-0012-GH |
| POWER | 1/5 HP |
| PRODUCT CAPACITY | 672 - 12 oz. cans |
| | 2 - kegs |
| PRODUCT CAPACITY | 384 - 12 oz. bottles |
| | |
| NUMBER OF DOORS | 2 |
| TEMPERATURE RANGE | 33°F - 41°F / 0.5°C - 5°C |
| CAPACITY | 11.8 cu. ft. / 335 L |
| NUMBER OF SHELVES | 4 |
| ELECTRICAL | 115V / 60Hz / 1Ph |
| AMPS | 2.88 |
| REFRIGERANT | R290 |
| DIMENSIONS (DWH) | 48.8" x 24.4" x 35.6" 1240 x 620 x 905 mm |
| INTERIOR DIMENSIONS (DWH) | 36 1/4" x 18 1/2" x 30 1/2" 920 x 470 x 775 mm |
| PACKAGING DIMENSIONS | 51 1/8" x 27 4/8" x 42 3/8" 1300 x 700 x 1075 mm |
| WEIGHT | 98 kg. / 216 lbs. |
| PACKAGING WEIGHT | 118 kg. / 260 lbs. |

TECHNICAL DRAWING AND DIMENSIONS

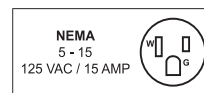
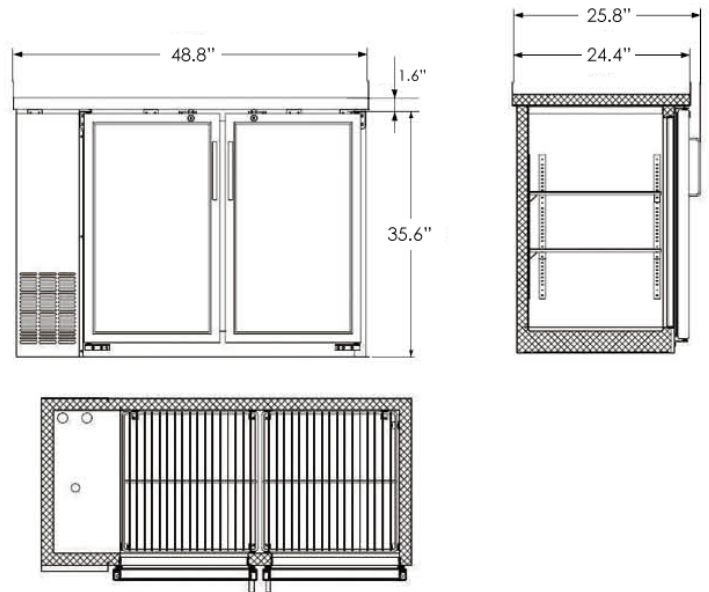

OMCAN INC.

Telephone: 1-800-465-0234

Fax: (905) 607-0234

Email: sales@omcan.com

Website: www.omcan.com



Follow us to keep up to date with the latest news and offers



2017.E.O.E

REFRIGERATION

61-INCH HEAVY DUTY GLASS DOOR BOTTLE COOLER



Features:

- Durable stainless steel top, interior walls, floor and ceiling
- Exterior construction is attractive corrosion resistant vinyl on steel in black finish
- Self-closing doors with locks
- LED interior lighting
- Adjustable heavy-duty PVC coated shelves
- Electronic control system makes it easy to adjust temperature set point and defrost frequency
- Temperature range from 0-5°C / 33-41°F



TECHNICAL SPECIFICATION

| | |
|---------------------------|-----------------------|
| ITEM NUMBER | 50060 |
| MODEL | BB-CN-0016-GH |
| POWER | 1/5 HP |
| PRODUCT CAPACITY | 912 - 12 oz. cans |
| | 2 - kegs |
| NUMBER OF DOORS | 2 |
| | TEMPERATURE RANGE |
| CAPACITY | 15.8 cu. ft. / 446 L |
| NUMBER OF SHELVES | 4 |
| ELECTRICAL | 115V / 60Hz / 1Ph |
| AMPS | 2.88 |
| REFRIGERANT | R290 |
| DIMENSIONS (WDH) | 60.8" x 24.4" x 35.6" |
| | 1544 x 620 x 905 mm |
| INTERIOR DIMENSIONS (DWH) | 20" x 48.2" x 31" |
| | 507 x 1224 x 787 mm |
| PACKAGING DIMENSIONS | 27.6" x 63.4" x 42.3" |
| | 701 x 1610 x 1074 mm |
| WEIGHT | 326 lbs. / 148 kg. |
| PACKAGING WEIGHT | 380 lbs. / 173 kg. |

TECHNICAL DRAWING AND DIMENSIONS

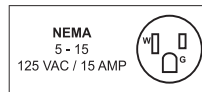
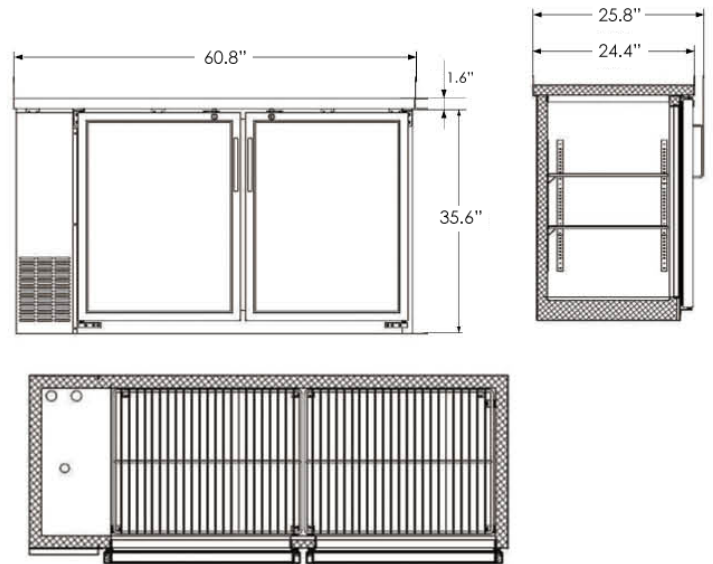

LIMITED WARRANTY

1 YEAR PARTS AND LABOR
5 YEARS PARTS ON COMPRESSOR

OMCAN INC.

Telephone: 1-800-465-0234

Fax: (905) 607-0234

Email: sales@omcan.com

Website: www.omcan.com



Follow us to keep up to date with the latest news and offers



2017.E.O.E

REFRIGERATION

73-INCH HEAVY DUTY GLASS DOOR BOTTLE COOLER



Features:

- Durable stainless steel top, interior walls, floor and ceiling
- Exterior construction is attractive corrosion resistant vinyl on steel in black finish
- Self-closing doors with locks
- LED interior lighting
- Adjustable heavy-duty PVC coated shelves
- Electronic control system makes it easy to adjust temperature set point and defrost frequency
- Temperature range from 0-5°C / 33-41°F



TECHNICAL SPECIFICATION

| | |
|---------------------------|-----------------------------------------------------|
| ITEM NUMBER | 50062 |
| MODEL | BB-CN-0020-GH |
| POWER | 1/4+ |
| PRODUCT CAPACITY | 1152 - 12 oz. cans |
| | 3 - kegs |
| NUMBER OF DOORS | 624 - 12 oz. bottles |
| | 3 |
| TEMPERATURE RANGE | 33°F - 41°F / 0.5°C - 5°C |
| CAPACITY | 19.6 cu. ft. / 556 L |
| NUMBER OF SHELVES | 6 |
| ELECTRICAL | 115V / 60Hz / 1Ph |
| AMPS | 3.96 |
| REFRIGERANT | R290 |
| DIMENSIONS (DWH) | 72 3/4" x 24 3/8" x 35 5/8" 1848 x 620 x 905 mm |
| INTERIOR DIMENSIONS (DWH) | 60 1/8" x 18 1/2" x 30 1/2" 1528 x 470 x 775 mm |
| PACKAGING DIMENSIONS | 75 2/8" x 27 4/8" x 42 3/8" 1910 x 700 x 1075 mm |
| WEIGHT | 141 kg. / 310 lbs. |
| PACKAGING WEIGHT | 175 kg. / 385 lbs. |

TECHNICAL DRAWING AND DIMENSIONS

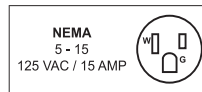
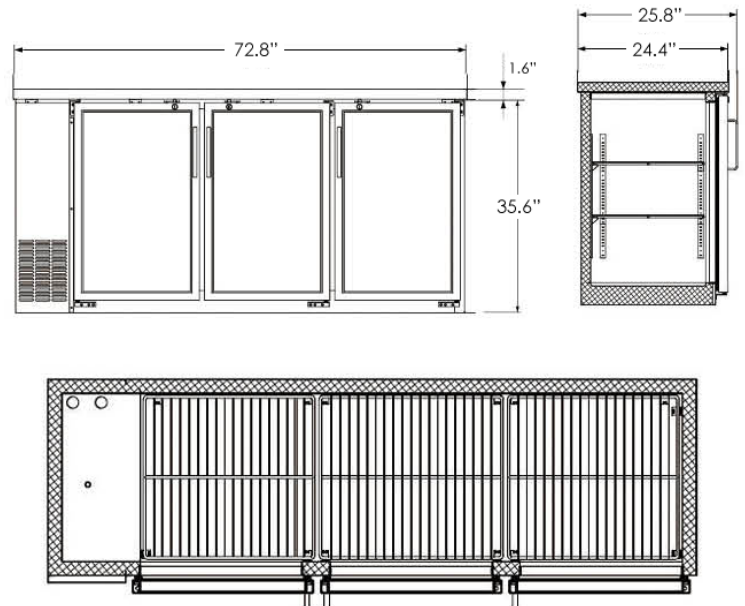

LIMITED WARRANTY

1 YEAR PARTS AND LABOR
5 YEARS PARTS ON COMPRESSOR

OMCAN INC.

Telephone: 1-800-465-0234

Fax: (905) 607-0234

Email: sales@omcan.com

Website: www.omcan.com



Follow us to keep up to date with the latest news and offers



2015.E.O.E